

## What's in the box



## Overview

### Baby unit overview

- 1 - POWER light
- 2 - ⏻ (On/off)
- 3 - Microphone
- 4 - Power jack

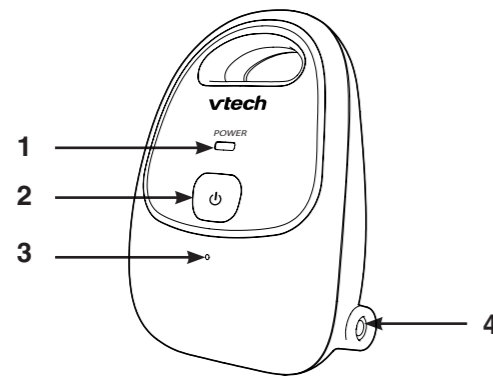

### Parent unit overview

- 1 - Visual sound indicator
- 2 - POWER / LINK light
- 3 - LOW BATTERY light
- 4 - ▼ (Volume down)
- 5 - ⏻ (On/off)
- 6 - Speaker
- 7 - Belt clip
- 8 - ▲ (Volume up)
- 9 - Battery compartment cover
- 10 - Power jack

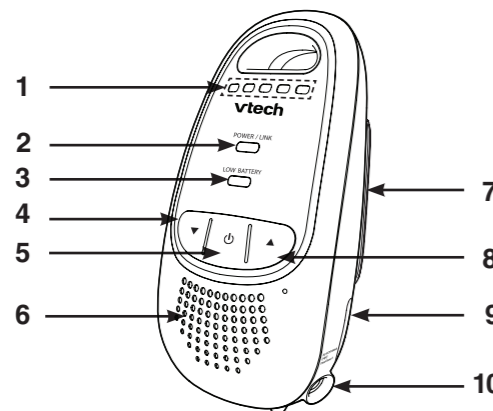

## Connect

### NOTES

- Use only the parent unit power adapter and the baby unit power adapter supplied with this product.
- The parent unit power adapter and baby unit power adapter are intended for a vertical or floor mount position. The prongs are not designed to hold the plug in place if it is plugged into a ceiling, under-the-table, or cabinet outlet.
- Make sure the parent unit, the baby unit and the power adapter cord are out of reach of children.
- Both the baby unit and the parent unit are on once connected to the power supply.

### Connect the baby unit

#### NOTE

- Make sure the **POWER** light is on after the power plug is fully inserted into the power jack of the baby unit.

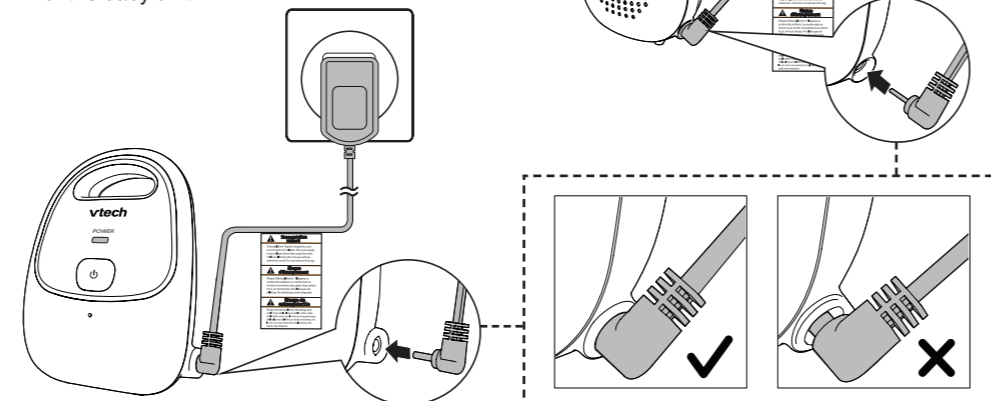

### Install batteries for temporary use

You are recommended to use the power adapter to power up the parent unit for normal use. If you want to move around the house with the parent unit, or there is a power outage, install two AAA alkaline batteries for temporary use.

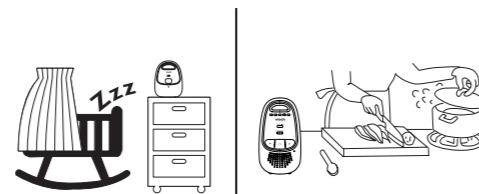

### Connect the baby unit

#### NOTES

- Make sure the **POWER / LINK** light is on after the power plug is fully inserted into the power jack of the parent unit.
- Make sure the baby unit is on. If the parent unit is not linked to the baby unit, the **POWER / LINK** light on the parent unit will flash. Move the parent unit closer to the baby unit (but not less than 1 meter / 3 feet).

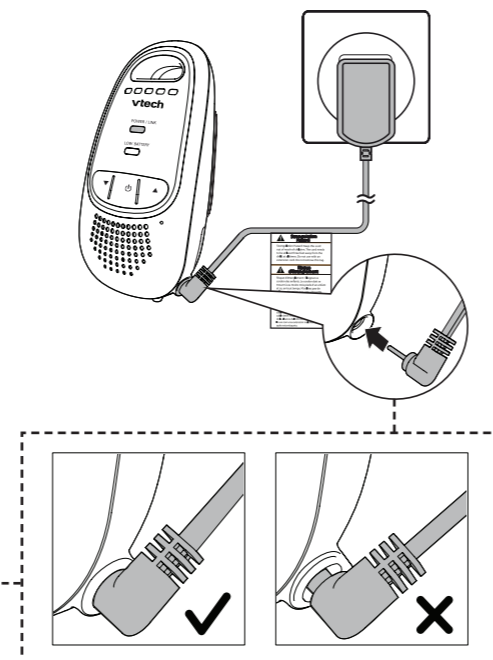

### Install the batteries on the parent unit

#### NOTES

- Use 2 x AAA batteries (not included). Alkaline batteries are recommended. If you use other kind of batteries, the performance of the baby monitor varies.
- The parent unit does not support battery recharging.
- Do not mix old and new batteries. Do not mix alkaline, standard (Carbon-Zinc) or rechargeable (Ni-Cad, Ni-Mh, etc) batteries.
- While you insert the batteries, make sure the polarities are correct.
- When the batteries are installed, the parent unit turns on.

## Connect | Install batteries for temporary use

1. Slide open the battery compartment cover.
2. Flip the ribbon across the battery compartment.

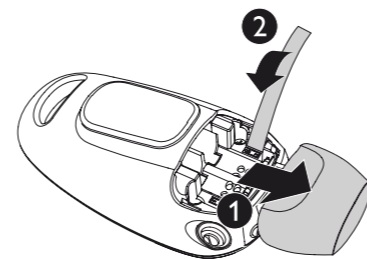

3. Insert two AAA **alkaline** batteries into the battery compartment on top of the ribbon.
4. Slide the battery compartment cover until it clicks into place.

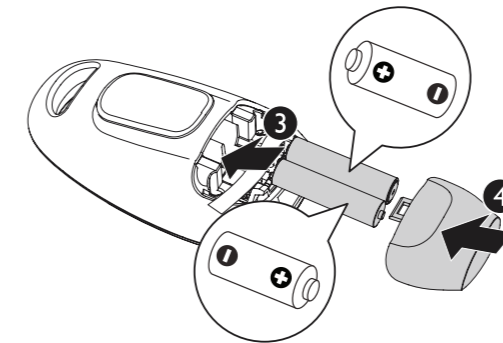

Replace the batteries when the **LOW BATTERY** light flashes on the parent unit, or you hear a beep every 10 minutes.

### Positioning the baby monitor

#### NOTE

- This baby monitor is intended as an aid. It is not a substitute for proper adult supervision, and should not be used as such.

**Warning:** Keep the baby unit out of the reach of the baby. Never place or mount the baby unit inside the baby's crib or playpen.

1. Place the baby unit at least 1 meter / 3 feet away from your baby.

#### NOTE

- If you experience audio feedback on either the parent unit or baby unit, move the parent unit further away until there is no more audio feedback.

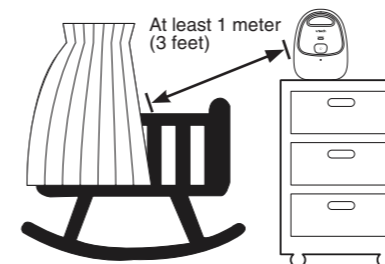

2. Place the parent unit at least 1 meter / 3 feet away from the baby unit.

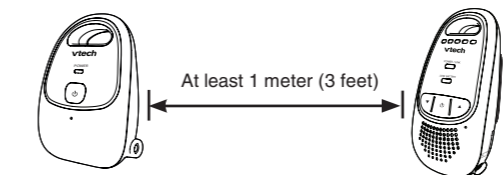

#### TIP

- You can increase the speaker volume of the parent unit if you cannot hear the sounds transmitted from the baby unit.

### Operating range

The operating range of the baby monitor is up to 300 meters (1000 feet) outdoors or 50 meters (160 feet) indoors. The actual operating range may vary depending on the environmental conditions, and other interferences such as walls, doors, and other obstructions.

## Before use

Test the sound transmission of the baby monitor before initial use, and at regular times thereafter.

Place the parent unit and the baby unit in the same room to test the product.

### To test the sound transmission:

- Speak towards the microphone of the baby unit. You will hear the sound at the parent unit, and see the visual sound indicators light up.

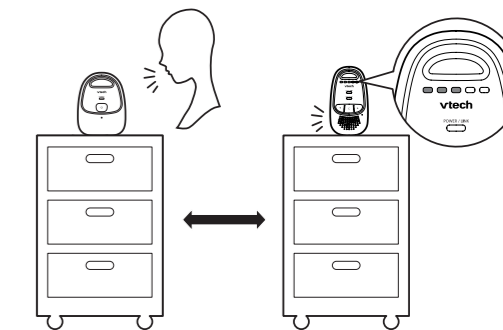

## Using your baby monitor

### Power on or off the baby unit

#### To turn on the baby unit:

- Press and hold ⏻ until the **POWER** light turns on.

#### To turn off the baby unit:

- Press and hold ⏻ until the **POWER** light turns off.

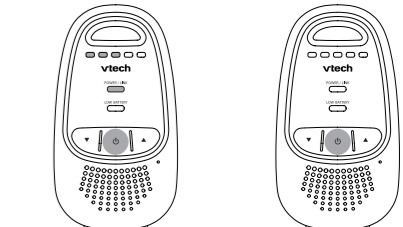
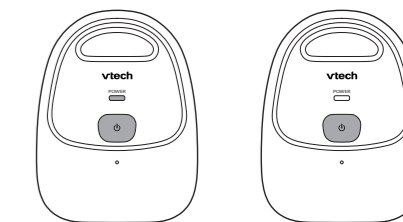

### Power on or off the parent unit

#### To turn on the parent unit:

- Press and hold ⏻ until the **POWER / LINK** light turns on.

#### To turn off the parent unit:

- Press and hold ⏻ until the **POWER / LINK** light turns off.

### Speaker volume of the parent unit

The speaker volume is preset to **Level 3** on the parent unit. You can adjust to your preferred sound level.

#### To adjust the speaker volume:

- Press ▼ to decrease the volume, and ▲ to increase the volume.

#### NOTE

- If you continue to press ▼ or ▲ when the volume reaches the minimum or maximum setting, the parent unit will beep once.

#### To mute the speaker volume:

- Press ▼ repeatedly until the volume reaches the minimum.

#### NOTES

- When the parent unit is in mute, the visual sound indicator will still indicate the sound detected from the baby unit.
- To unmute, press ▲ repeatedly until it reaches your desired volume.

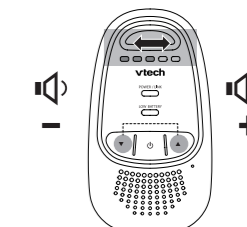

## Before use | Using your baby monitor

## Technical Specifications





Frequency control	Crystal controlled PLL synthesizer
Transmit frequency	Baby unit: 1921.536-1928.448 MHz Parent unit: 1921.536-1928.448 MHz
Channels	5
Nominal effective range	Maximum power allowed by FCC and IC. Actual operating range may vary according to environmental conditions at the time of use.
Power requirements	Baby unit adapter: Input: 117V AC 60Hz Output: 6V AC @ 300mA  Parent unit adapter: Input: 100-120V AC 60Hz Output: 6V DC @ 400mA  Parent unit battery: 2 X AAA alkaline batteries

## Lights and alert tones

### Baby unit light

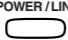
	<b>POWER light</b> <ul style="list-style-type: none"> <li>Lights off when the baby unit is off.</li> <li>Lights on in green when the baby unit is on.</li> </ul>
---	--

### Parent unit light

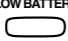
	<b>POWER / LINK light</b> <ul style="list-style-type: none"> <li>Lights off when the parent unit is off.</li> <li>Lights on in green when the parent unit is on and linked to the baby unit.</li> <li>Flashes in green when there is no link between the baby unit and parent unit, or when the parent unit is out of range from the baby unit.</li> </ul>
	<b>Visual sound indicator</b> The visual sound indicator has two functions. One is to show the sound level detected by the baby unit. The other one is to show the volume level during speaker volume setting.
	<b>Sound level detected by the baby unit</b> <ul style="list-style-type: none"> <li>One to three green lights indicate a moderate sound level detected by the baby unit.</li> <li>Additional red lights indicate a higher sound level detected by the baby unit (e.g. baby crying loudly).</li> </ul>
	<b>Speaker volume level</b> <ul style="list-style-type: none"> <li>One to three green lights indicate <b>Level 1 to Level 3</b> of the speaker volume setting.</li> <li>Additional red lights indicate <b>Level 4 to Level 5</b> of the speaker volume setting.</li> </ul>
	<b>LOW BATTERY light</b> <ul style="list-style-type: none"> <li>Flashes in red when the battery is low.</li> </ul>

### Parent unit alert tones

<b>Low battery tone</b>	• Beeps once every 10 minutes when the battery is low.
<b>Out of range tone</b>	• Beeps four times every 30 seconds when there is no link between the baby unit and parent unit, or when the parent unit is out of range from the baby unit.

## General product care

To clean and maintain this product:

- Avoid putting it near heating appliances and devices that generate electrical noise (for example, motors or fluorescent lamps).
- DO NOT expose it to direct sunlight or moisture.
- Avoid dropping the product or treating it roughly.
- Clean with a soft cloth.
- DO NOT immerse the parent unit and the baby unit in water and do not clean them under the tap.
- DO NOT use cleaning spray or liquid cleaners.
- Make sure the baby unit and parent unit are dry before you connect them to the power supply.

## Storage

When you are not going to use the baby monitor for some time, remove the batteries from the parent unit. Store the parent unit, the baby unit and the adapters in a cool and dry place.

## Operating range

This product operates with the maximum power allowed by the Federal Communications Commission (FCC). Even so, the baby unit and the parent unit can communicate over only a certain distance - which can vary with the locations of the baby unit, the parent unit, the weather, and the layout of your home. When the parent unit is out of range, it will beep four times every 30 seconds and enter searching mode. To improve reception, move closer to the baby unit (but not less than 1 meter / 3 feet).

## Frequently asked questions

Below are the questions most frequently asked about the baby monitor. If you cannot find the answer to your question, visit our website at [www.vtechphones.com](http://www.vtechphones.com) or call **1 (800) 595-9511** for customer service. In Canada, go to [www.vtechcanada.com](http://www.vtechcanada.com) or call **1 (800) 267-7377**.

Why doesn't the <b>POWER</b> light on the baby unit turn on when I switch on the units?	Perhaps the baby unit is not connected to the power supply. Connect the baby unit to power supply. The baby unit turns on.
Why doesn't the <b>POWER / LINK</b> light on the parent unit turn on when I switch on the units?	Perhaps the battery of the parent unit is empty and the parent unit is not connected to power supply. Connect the parent unit to power supply; or insert two new AAA alkaline batteries into the parent unit. The parent unit turns on and establishes connection with the baby unit.
Why does the baby monitor not respond normally?	Try the following (in the order listed) for common cure: 1. Make sure that both baby unit and parent unit are on. Disconnect the power from the baby unit and the parent unit. 2. Remove the batteries from the parent unit. 3. Connect the baby unit to the power supply again. The baby unit turns on. 4. Connect the parent unit to the power supply again; or insert two new AAA alkaline batteries. The parent unit turns on. 5. Wait for the parent unit to synchronize with the baby unit. Allow up to one minute for this to take place. 6. Press ▼ or ▲ to adjust the speaker volume on the parent unit.
Why does the baby monitor produce a high-pitched noise?	The units may be too close to each other. Make sure the parent unit and the baby unit at least 1 meter / 3 feet away from each other.
Why don't I hear a sound/ Why can't I hear my baby cry?	Make sure that both baby unit and parent unit are on. If you see the visual sound indicators light up, but there is no sound, then you may have muted the volume or set it to a lower level. Adjust the volume to a higher level.  If the visual sound indicators do not light up, and you cannot hear any sound, it is because the baby sound is too low for the baby unit to detect. This is normal. Place the baby unit at least 1 meter / 3 feet away from your baby.
Why does the parent unit beep?	The parent unit beeps twice every 5 minutes when the baby unit is out of range. Move the parent unit closer to the baby unit (but not less than 1 meter / 3 feet).  If the parent unit is powered by batteries, the parent unit beeps once every 10 minutes when the battery is low. Replace with two new AAA alkaline batteries.
Why does the parent unit <b>LOW BATTERY</b> light flash?	If the parent unit is powered by batteries, the parent unit beeps once every 10 minutes when the battery is low. Replace with two new AAA alkaline batteries, or remove the batteries, and connect the parent unit to the power supply.
Why can't I establish a connection? Why is the connection lost every now and then? Why are there sound interruptions?	The baby unit may be out of range. Move the parent unit closer to the baby unit (but not less than 1 meter / 3 feet). Other electronic products may cause interference with your baby monitor. Try installing your baby monitor as far away from these electronic devices as possible.

## Limited warranty

### What does this limited warranty cover?

The manufacturer of this VTech Product warrants to the holder of a valid proof of purchase ("Consumer" or "you") that the Product and all accessories provided in the sales package ("Product") are free from defects in material and workmanship, pursuant to the following terms and conditions, when installed and used normally and in accordance with the Product operating instructions. This limited warranty extends only to the Consumer for Products purchased and used in the United States of America and Canada.

### What will VTech do if the Product is not free from defects in materials and workmanship during the limited warranty period ("Materially Defective Product")?

During the limited warranty period, VTech's authorized service representative will repair or replace at VTech's option, without charge, a Materially Defective Product. If we repair the Product, we may use new or refurbished replacement parts. If we choose to replace the Product, we may replace it with a new or refurbished Product of the same or similar design. We will retain defective parts, modules, or equipment. Repair or replacement of the Product, at VTech's option, is your exclusive remedy. VTech will return the repaired or replacement Products to you in working condition. You should expect the repair or replacement to take approximately 30 days.

### How long is the limited warranty period?

The limited warranty period for the Product extends for ONE (1) YEAR from the date of purchase. If VTech repairs or replaces a Materially Defective Product under the terms of this limited warranty, this limited warranty also applies to the repaired or replacement Product for a period of either (a) 90 days from the date the repaired or replacement Product is shipped to you or (b) the time remaining on the original one-year warranty; whichever is longer.

### What is not covered by this limited warranty?

This limited warranty does not cover:

- Product that has been subjected to misuse, accident, shipping or other physical damage, improper installation, abnormal operation or handling, neglect, inundation, fire, water or other liquid intrusion; or
- Product that has been damaged due to repair, alteration or modification by anyone other than an authorized service representative of VTech; or
- Product to the extent that the problem experienced is caused by signal conditions, network reliability, or cable or antenna systems; or
- Product to the extent that the problem is caused by use with non-VTech accessories; or
- Product whose warranty/quality stickers, product serial number plates or electronic serial numbers have been removed, altered or rendered illegible; or
- Product purchased, used, serviced, or shipped for repair from outside the United States of America or Canada, or used for commercial or institutional purposes (including but not limited to Products used for rental purposes); or
- Product returned without a valid proof of purchase (see item 2 on the next page); or
- Charges for installation or set up, adjustment of customer controls, and installation or repair of systems outside the unit.

### How do you get warranty service?

To obtain warranty service in the United States of America, visit [www.vtechphones.com](http://www.vtechphones.com) or call **1 (800) 595-9511**. In Canada, go to [www.vtechcanada.com](http://www.vtechcanada.com) or call **1 (800) 267-7377**.

NOTE: Before calling for service, please review the user's manual - a check of the Product's controls and features may save you a service call.

Except as provided by applicable law, you assume the risk of loss or damage during transit and transportation and are responsible for delivery or handling charges incurred in the transport of the Product(s) to the service location. VTech will return repaired or replaced Product under this limited warranty. Transportation, delivery or handling charges are prepaid. VTech assumes no risk for damage or loss of the Product in transit. If the Product failure is not covered by this limited warranty, or proof of purchase does not meet the terms of this limited warranty, VTech will notify you and will request that you authorize the cost of repair prior to any further repair activity. You must pay for the cost of repair and return shipping costs for the repair of Products that are not covered by this limited warranty.

### What must you return with the Product to get warranty service?

- Return the entire original package and contents including the Product to the VTech service location along with a description of the malfunction or difficulty; and
- Include a "valid proof of purchase" (sales receipt) identifying the Product purchased (Product model) and the date of purchase or receipt; and
- Provide your name, complete and correct mailing address, and telephone number.

### Other limitations

This warranty is the complete and exclusive agreement between you and VTech. It supersedes all other written or oral communications related to this Product. VTech provides no other warranties for this Product. The warranty exclusively describes all of VTech's responsibilities regarding the Product. There are no other express warranties. No one is authorized to make modifications to this limited warranty and you should not rely on any such modification.

State/Provincial Law Rights: This warranty gives you specific legal rights, and you may also have other rights, which vary from state to state or province to province.

Limitations: Implied warranties, including those of fitness for a particular purpose and merchantability (an unwritten warranty that the Product is fit for ordinary use) are limited to one year from the date of purchase. Some states/provinces do not allow limitations on how long an implied warranty lasts, so the above limitation may not apply to you. In no event shall VTech be liable for any indirect, special, incidental, consequential, or similar damages (including, but not limited to lost profits or revenue, inability to use the Product or other associated equipment, the cost of substitute equipment, and claims by third parties) resulting from the use of this Product. Some states/provinces do not allow the exclusion or limitation of incidental or consequential damages, so the above limitation or exclusion may not apply to you.

**Please retain your original sales receipt as proof of purchase.**

Go to [www.vtechphones.com](http://www.vtechphones.com) to register your product for enhanced warranty support and latest VTech product news.

## DM111 DM111-2 Safe&Sound® Digital Audio Baby Monitor



## vtech® User's manual

## Congratulations

on purchasing your new VTech product. Before using this product, please read **Important safety instructions**.

For support, shopping, and everything new at VTech, visit our website at [www.vtechphones.com](http://www.vtechphones.com). In Canada, please visit [www.vtechcanada.com](http://www.vtechcanada.com).



**V** Designed to fit your home.  
And your life.

VTech Communications, Inc.  
A member of THE VTECH GROUP OF COMPANIES.  
VTech is the registered trademark of VTech Holdings Limited.  
Safe&Sound® is a registered trademark of VTech Communications, Inc.  
Specifications are subject to change without notice.  
© 2014 for VTech Communications, Inc.  
All rights reserved. 09/14. DM111-X\_CIB\_V6.0  
Document order number: 91-007297-060-100